

Notes:
 1. High Rail (2023) This drawing is conditional and the copyright in its content remains with the relevant High Rail project. The user of this drawing shall not be taken to constitute an endorsement in favour of or against any product or service without the prior written consent of the relevant High Rail project.
 2. Construction works for High Rail (2023) shall be in accordance with the relevant High Rail project.
 3. Construction works for High Rail (2023) shall be in accordance with the relevant High Rail project.
 4. Construction works for High Rail (2023) shall be in accordance with the relevant High Rail project.
 5. Construction works for High Rail (2023) shall be in accordance with the relevant High Rail project.
 6. Construction works for High Rail (2023) shall be in accordance with the relevant High Rail project.
 7. Construction works for High Rail (2023) shall be in accordance with the relevant High Rail project.
 8. Construction works for High Rail (2023) shall be in accordance with the relevant High Rail project.
 9. Construction works for High Rail (2023) shall be in accordance with the relevant High Rail project.
 10. Construction works for High Rail (2023) shall be in accordance with the relevant High Rail project.

Contract Information:
 Client: **Irish Rail**
 Project Name: **High Rail (2023)**
 Project No: **20075-00**
 Drawing Title: **DART+ COASTAL NORTH**
 Project Location: **DONMATE STATION AND SUBROUNDS**



Rev	Date	Drawn	Checked	App'd	Description
P01	14/04/2023	SR	RS	GS	ISSUED FOR PUBLIC CONSULTATION 2

Date:	14/04/2023	Scale:	1:2500 @ A1
Project Code:	20075-00	Originator:	ARUP
Drawn:	SR	Checked:	RS
App'd:	GS	Approved:	GS

Project Title: 12/2
Drawing Title: DART+ COASTAL NORTH
Project Location: DONMATE STATION AND SUBROUNDS
Sheet Number: S3
Scale: 1:2500
Revision: P01

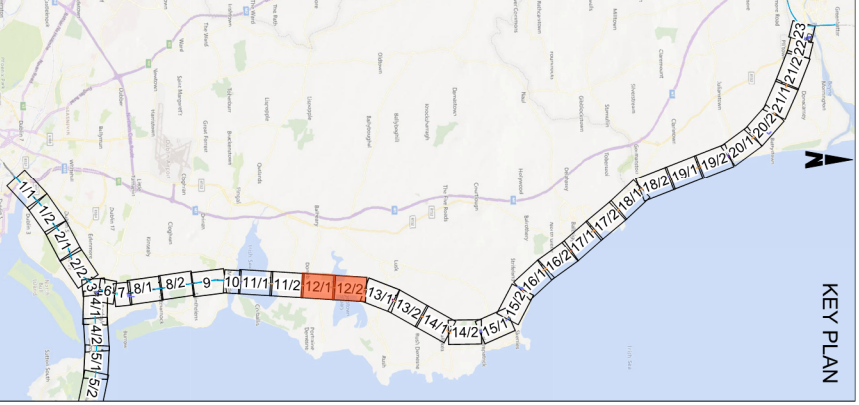
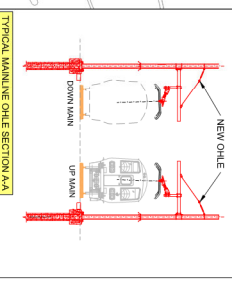
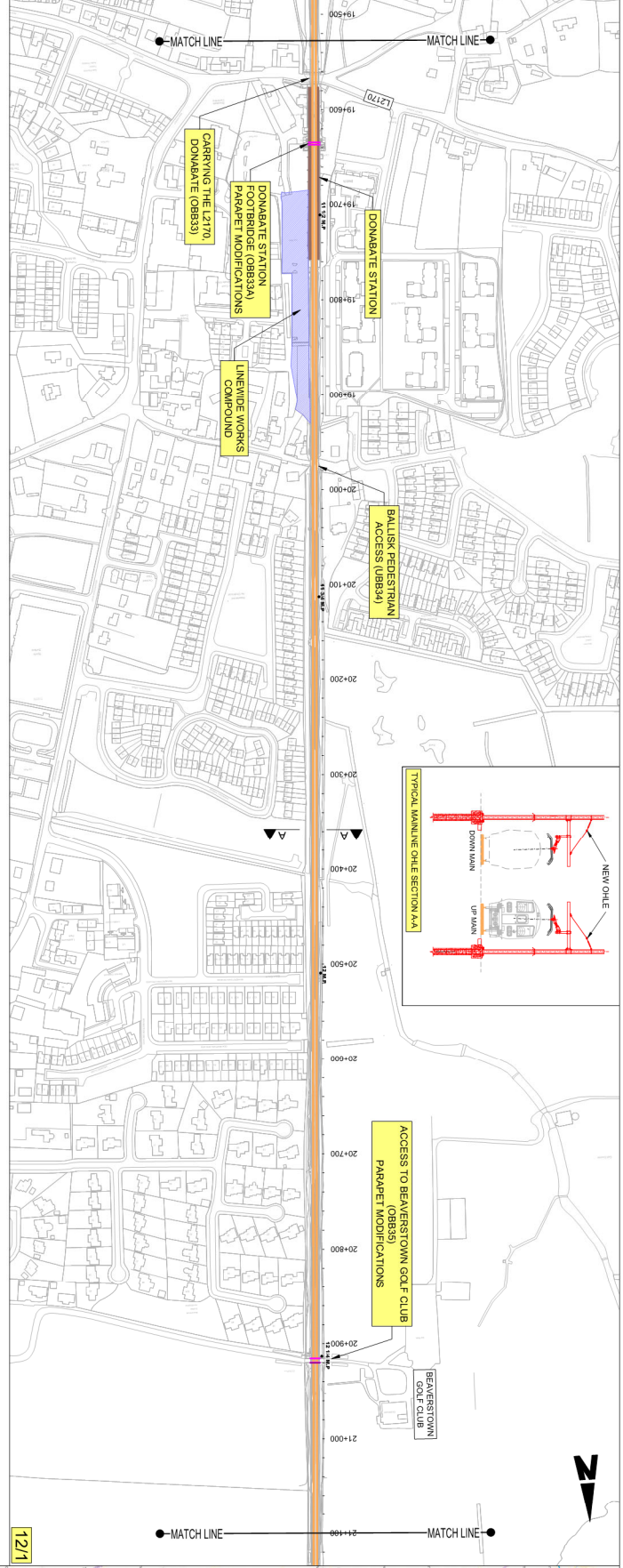
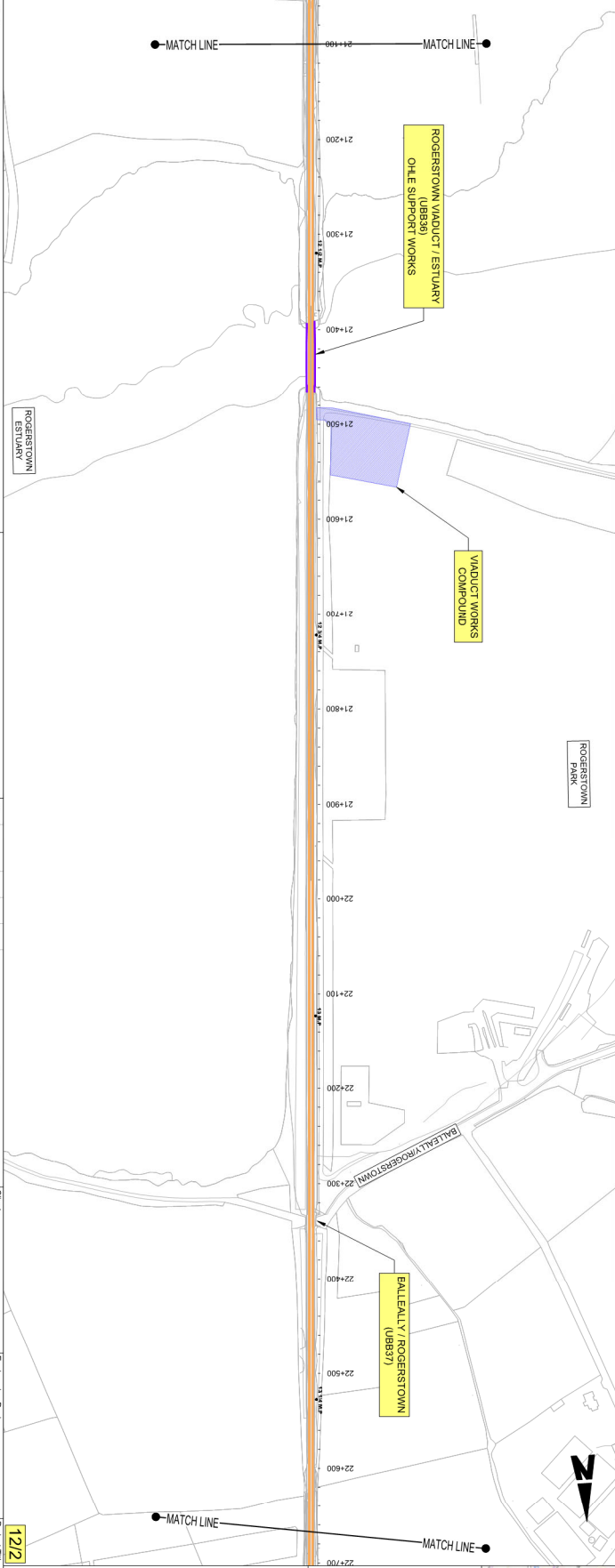

LEGEND:

[Red line]	NEW ELECTRIFICATION AND TRACK MODIFICATION IN EXISTING PAUL CORRIDOR
[Blue line]	EXISTING PAUL CORRIDOR - MINIMAL OR NO WORKS REQUIRED
[Orange line]	NEW ELECTRIFICATION IN EXISTING PAUL CORRIDOR
[Purple line]	PARAPET MODIFICATIONS
[Pink line]	OHLE SUPPORT ON UNDERBRIDGES
[Green hatched]	PROPOSED SUBSTITUTION
[Blue hatched]	CONSTRUCTION COMPOUND
[Brown hatched]	EXISTING STATION
[Brown rectangle]	BRIDGES
[Blue rectangle]	ORXX - EXISTING BRIDGE / ROAD OVER RAILWAY CORRIDOR
[Pink rectangle]	UBXX - EXISTING BRIDGE / ROAD/PIER UNDER RAILWAY CORRIDOR