

## Appendix B

### Drawings

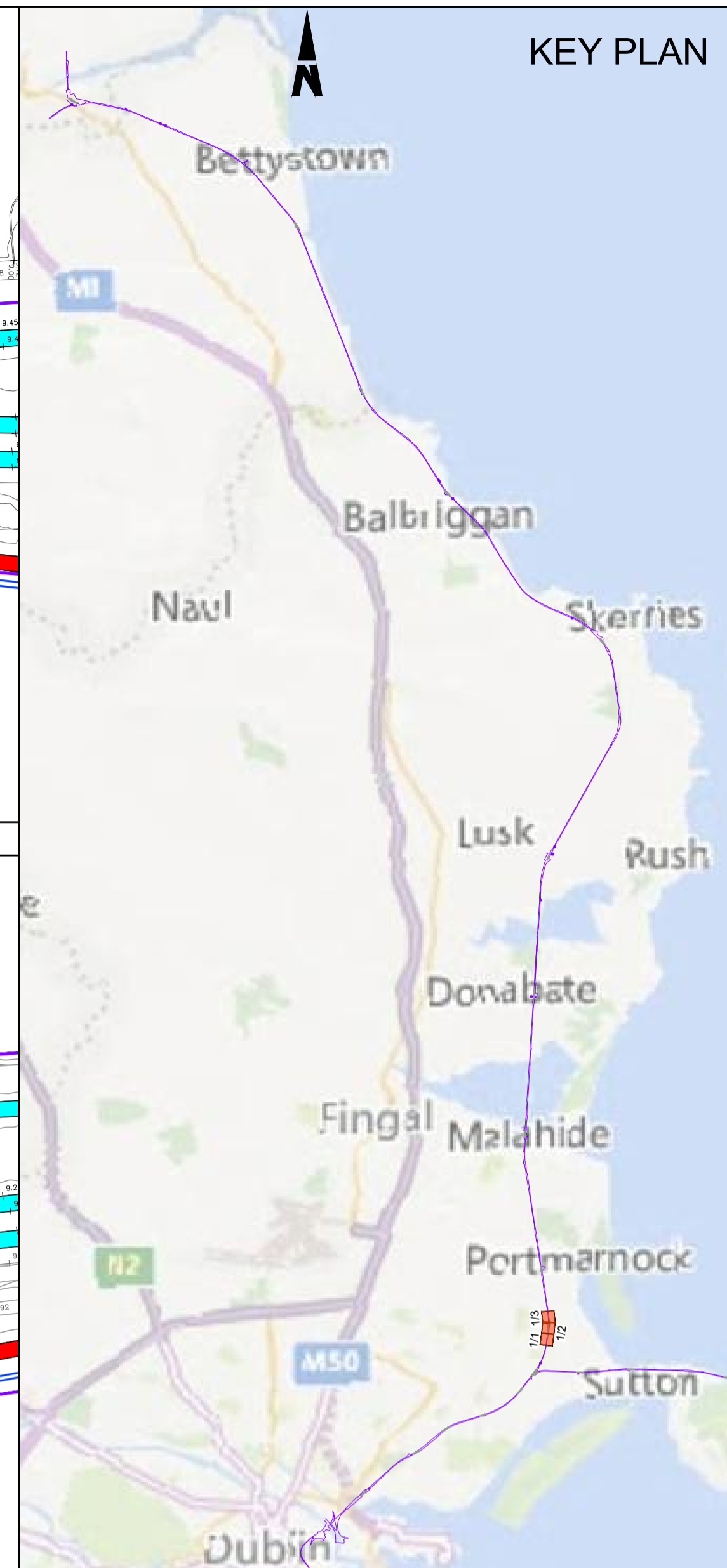

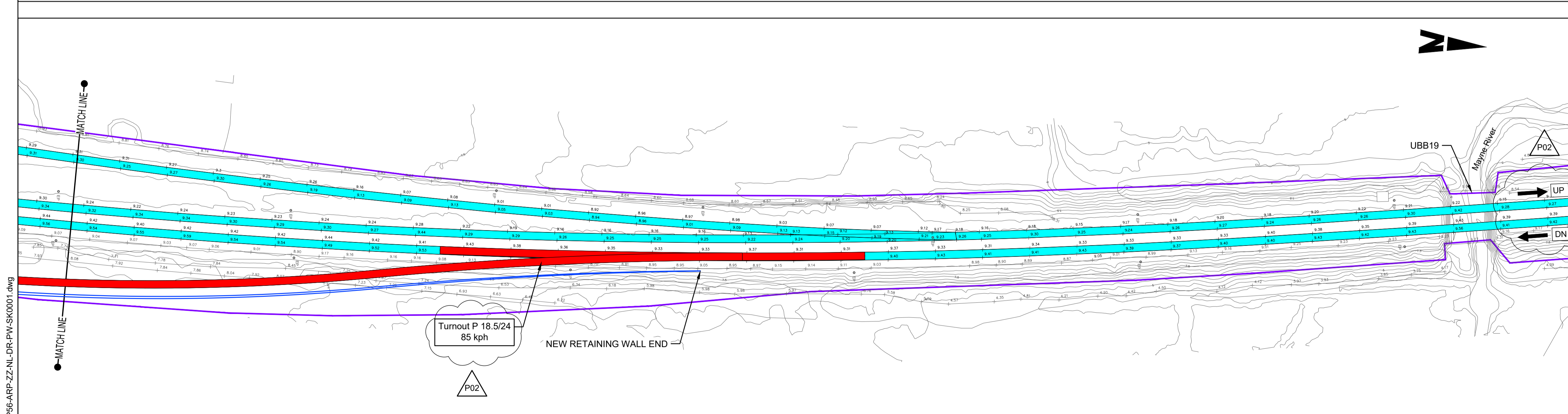
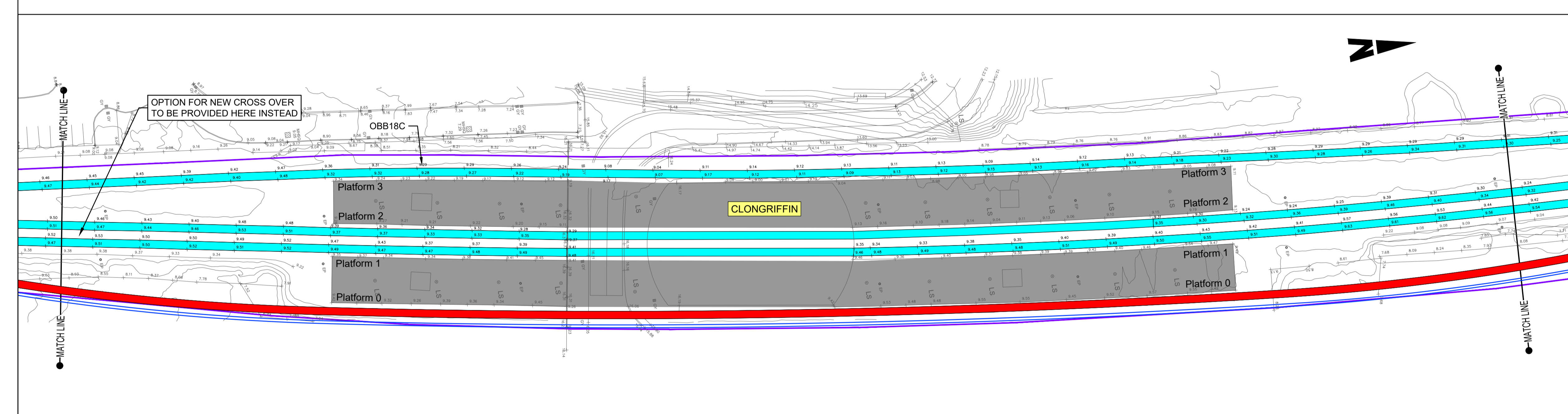

**LEGEND:**

- IRISH RAIL PROPERTY BOUNDARY
- EXISTING RAIL TRACK RETAINED
- EXISTING RAIL TRACK REMOVED
- NEW RAIL TRACK
- EXISTING STATION
- NEW RETAINING WALL

**BRIDGES**

- OBB18C Access road at Clongriffin Station - Overbridge
- UBB19 Mayne River & Cattle Pass - Underbridge

**Disclaimer**

© Irish Rail (2021). This drawing is confidential and the copyright in it is owned by Irish Rail. This drawing must not be either loaned, copied or otherwise reproduced in whole or in part or used for any purpose without the prior permission of Irish Rail.

© OpenStreetMap contributors

© Ordnance Survey Ireland and Government of Ireland. All O.S. data used for plans are printed under "Copyright Ordnance Survey Ireland" Survey No. 0039720 (OSi Aerial Data or OSi Lidar Data) & Survey No. 2021051 (NMA, 100 OSi Vector Data). All elevations are in metres and relate to OSi Geoid Model (OSGM02) Malin Head as defined by existing Project Control. All Co-ordinates are in Irish Transverse Mercator Grid (ITM) as defined by OSi active GPS station Tallaght College (TL165).

Rev	Date	Drn	Chk'd	App'd	Description
P01	30/08/2021	SR	AS	CL	--
P02	10/12/2021	SR	AS	GS	--
P03	19/01/2022	MF	RS	GS	--

**Client**

**Engineering Designer**

**Date** 19/01/2022 **Scale** 1:500 @ A1  
1:1000 @ A3

**Project Code** D+WP56 **Originator Code** ARP

**Drawn** MF **Checked** RS **Approved** GS

**QMS Code** 280275-00

<b>Project Title</b>		<b>DART+ COASTAL NORTH</b>	
<b>Drawing Title</b>		CLONGRIFIN STATION GENERAL ARRANGEMENT OPTION - 3A	
<b>Drawing File Name</b>	D+WP56-ARP-ZZ-NL-DR-PW-SK0001	<b>Sheet Number</b>	1 of 1
<b>Status</b>	S3	<b>Rev</b>	P03

DO NOT SCALE USE FIGURED DIMENSIONS ONLY

C:\DART\Malahide\Options\WP56-ARP-ZZ-NL-DR-PW-SK0001.dwg



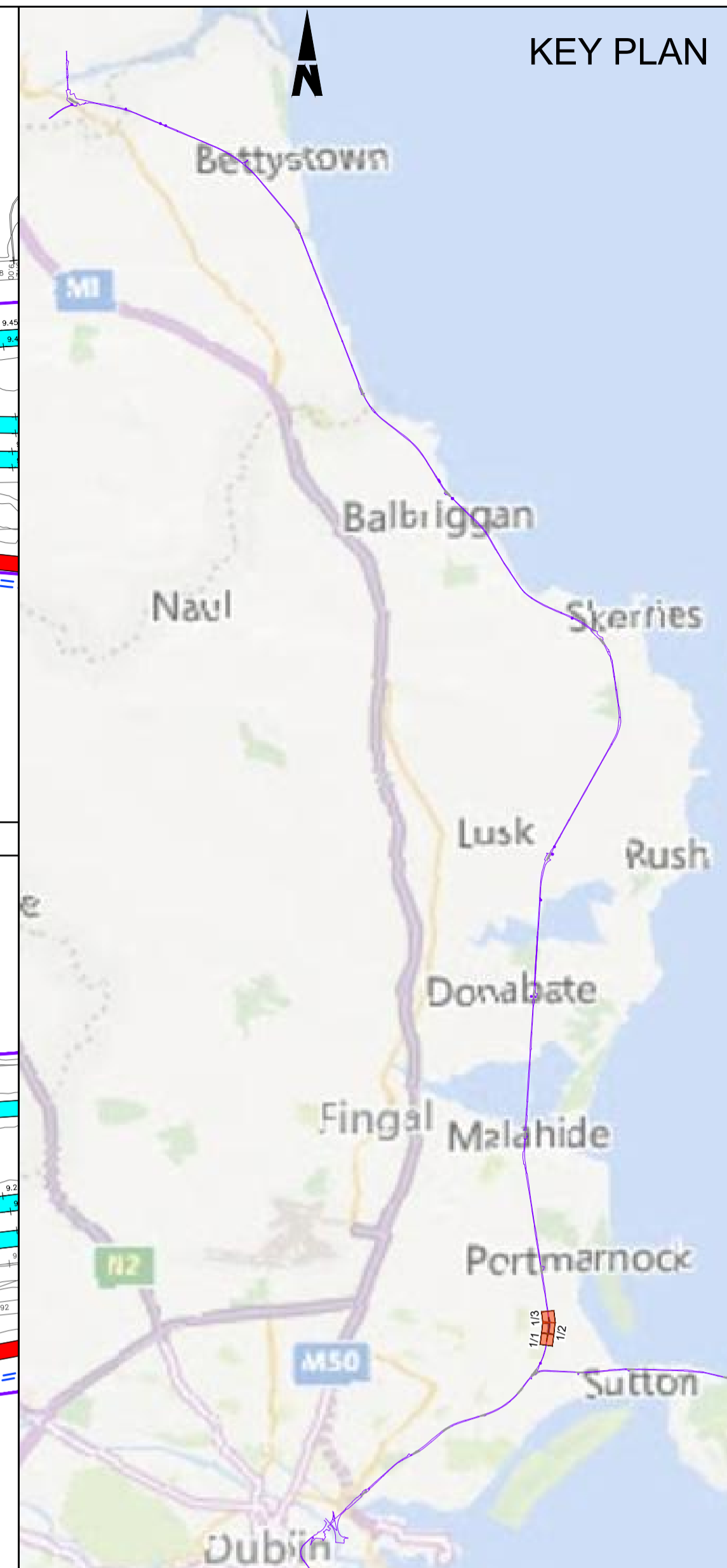
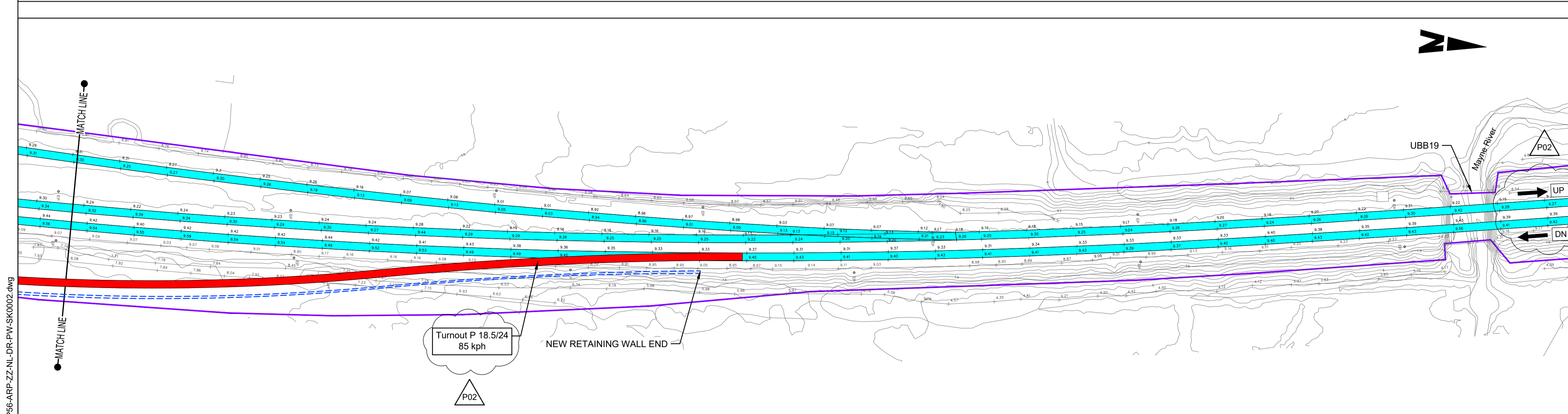
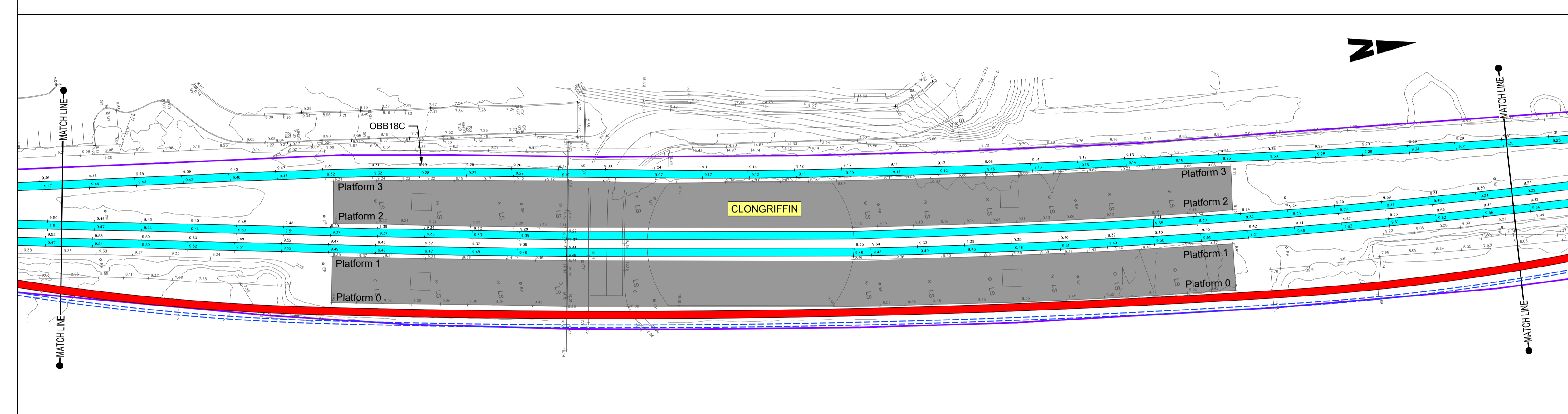

**LEGEND:**

- IRISH RAIL PROPERTY BOUNDARY
- EXISTING RAIL TRACK RETAINED
- EXISTING RAIL TRACK REMOVED
- NEW RAIL TRACK
- EXISTING STATION
- NEW RETAINING WALL

**BRIDGES**

- OB18C Access road at Clongriffin Station - Overbridge
- UBB19 Mayne River & Cattle Pass - Underbridge

**Disclaimer**

© Irish Rail (2021). This drawing is confidential and the copyright in it is owned by Irish Rail. This drawing must not be either loaned, copied or otherwise reproduced in whole or in part or used for any purpose without the prior permission of Irish Rail.

© OpenStreetMap contributors.

© Ordnance Survey Ireland and Government of Ireland. All O.S. data used for plans are printed under "Copyright Ordnance Survey Ireland" Survey No. 0039720 (OSi Aerial Data or OSi Lidar Data) & Survey No. 2021051 (NMA, 100 OSi Vector Data). All elevations are in metres and relate to OSi Geoid Model (OSGM02) Malin Head as defined by existing Project Control. All Co-ordinates are in Irish Transverse Mercator Grid (ITM) as defined by OSi active GPS station Tallaght College (TL45).



Rev	Date	Drn	Chk'd	App'd	Description
P01	30/08/2021	SR	AS	CL	--
P02	10/12/2021	SR	AS	GS	--
P03	19/01/2022	MF	RS	GS	--

		<b>Engineering Designer</b> 		
Date	Scale	Drawn	Checked	Approved
19/01/2022	1:500 @ A1 1:1000 @ A3	MF	RS	GS
Project Code	Originator Code	QMS Code	280275-00	
D+WP56	ARP			

<b>Project Title</b> DART+ COASTAL NORTH		<b>Drawing Title</b> CLONGRIFFIN STATION GENERAL ARRANGEMENT OPTION - 4	
<b>Drawing File Name</b> D+WP56-ARP-ZZ-NL-DR-PW-SK0002	<b>Sheet Number</b> 1 of 1	<b>Status</b> S3	<b>Rev</b> P03

DO NOT SCALE USE FIGURED DIMENSIONS ONLY



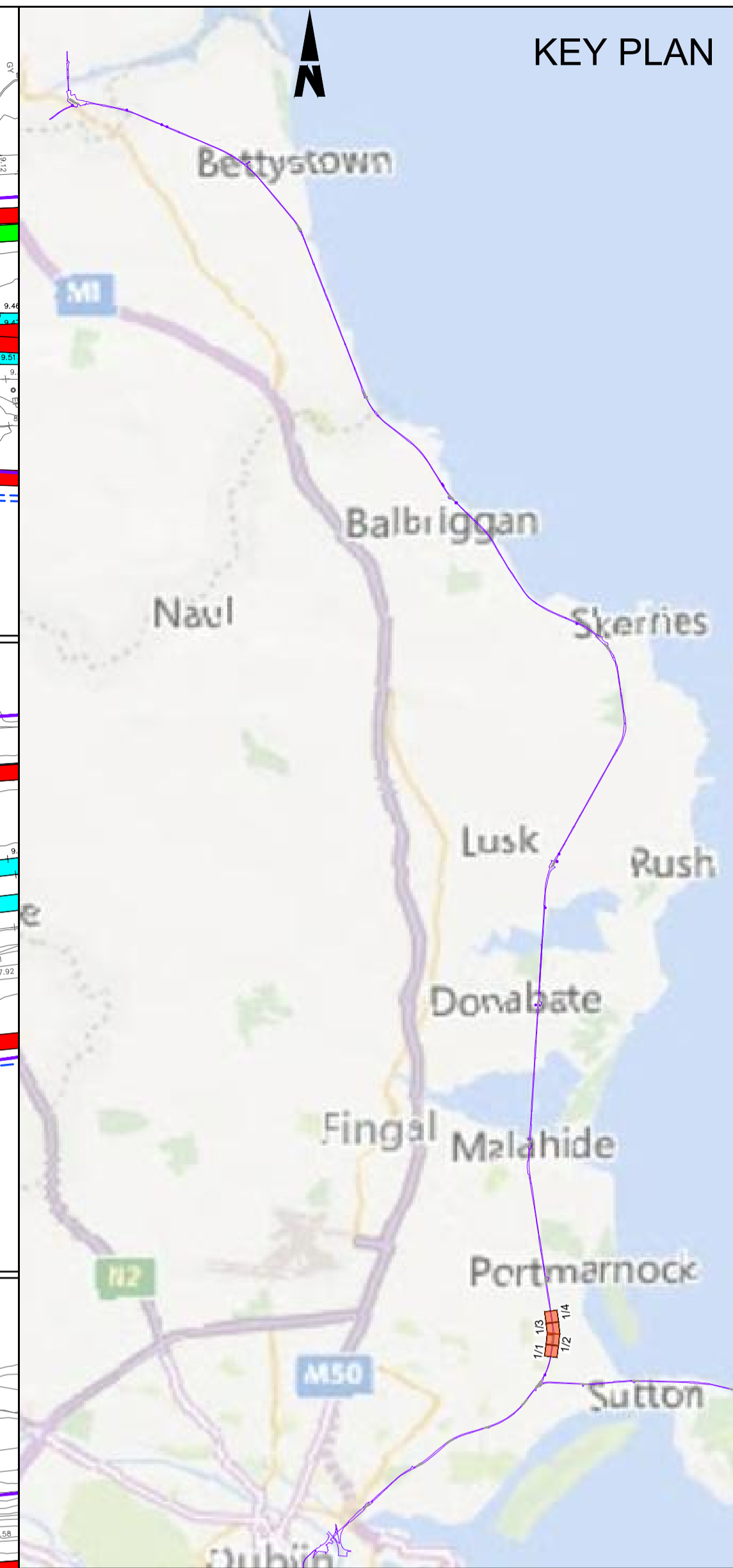
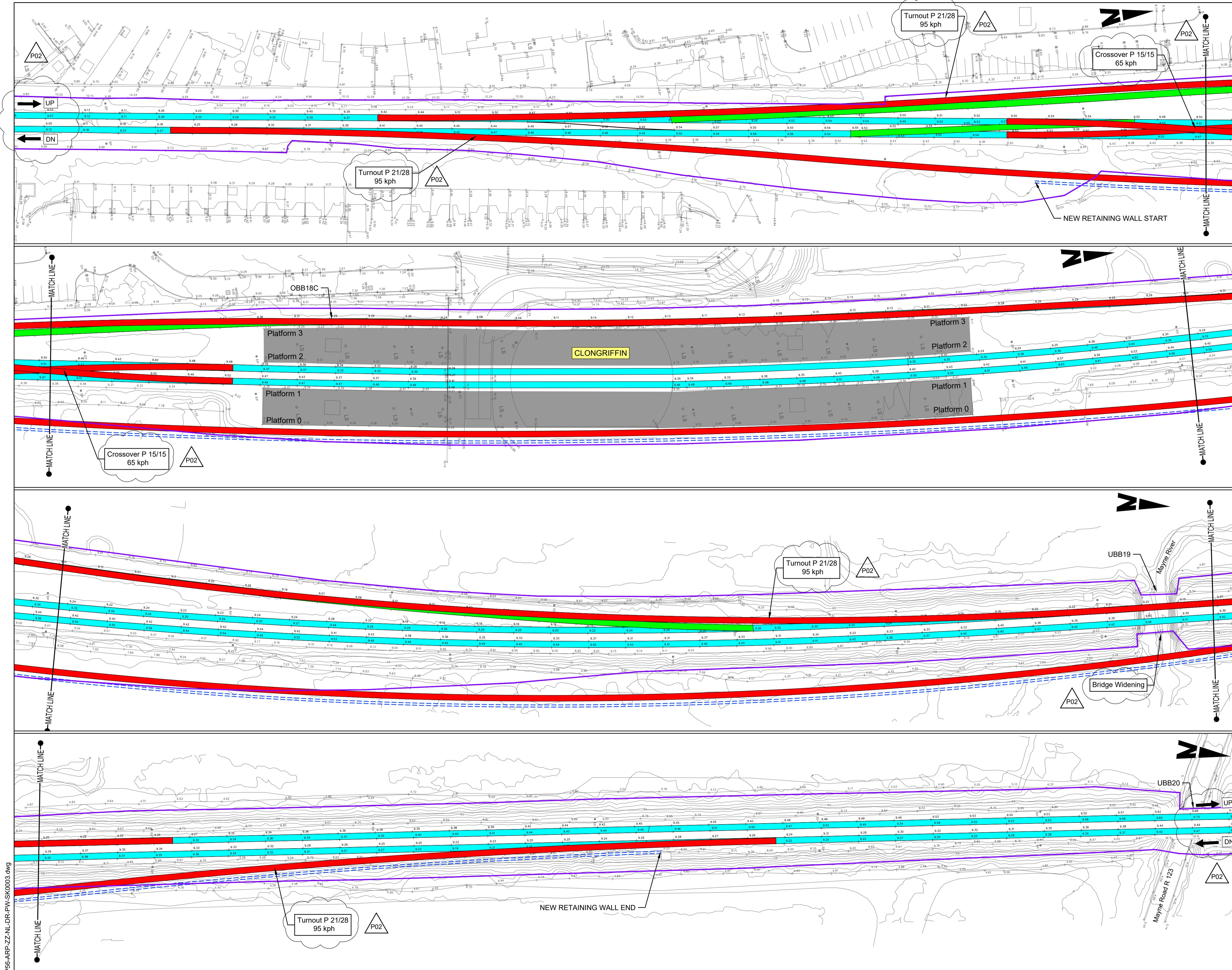

**LEGEND:**

- IRISH RAIL PROPERTY BOUNDARY
- EXISTING RAIL TRACK RETAINED
- EXISTING RAIL TRACK REMOVED
- NEW RAIL TRACK
- EXISTING STATION
- NEW RETAINING WALL

**BRIDGES**

- OBB18C Access road at Clongriffin Station - Overbridge
- UBB19 Mayne River & Cattle Pass - Underbridge
- UBB20 Mayne Road R 123 - Underbridge

**Disclaimer**

© Irish Rail (2021). This drawing is confidential and the copyright in it is owned by Irish Rail. This drawing must not be either loaned, copied or otherwise reproduced in whole or in part or used for any purpose without the prior permission of Irish Rail.

© OpenStreetMap contributors.

© Ordnance Survey Ireland and Government of Ireland. All O.S. data used for plans are printed under "Copyright Ordnance Survey Ireland" Survey No. 0039720 (OSi Aerial Data or OSi Lidar Data) & Survey No. 2021051\_NMA\_180 (OSi Vector Data). All elevations are in metres and relate to OSi Geoid Model (OSGM02) Malin Head as defined by existing Project Control. All Co-ordinates are in Irish Transverse Mercator Grid (ITM) as defined by OSi active GPS station Tallaght College (TLTG).

Rev	Date	Drn	Chk'd	App'd	Description
P01	30/08/2021	SR	AS	CL	--
P02	10/12/2021	SR	AS	GS	--
P03	19/01/2022	MF	RS	GS	--

**Client**

**Engineering Designer**

**Date** 19/01/2022 **Scale** 1:500 @ A1  
1:1000 @ A3

**Project Code** D+WP56 **Originator Code** ARP **QMS Code** 280275-00

**Drawn** MF **Checked** RS **Approved** GS

**Project Title**

**DART+ COASTAL NORTH**

**Drawing Title**

**CLONGRIFFIN STATION  
GENERAL ARRANGEMENT  
OPTION - 5**

**Drawing File Name** D+WP56-ARP-ZZ-NL-DR-PW-SK0003 **Sheet Number** 1 of 1 **Status** S3 **Rev** P03

DO NOT SCALE USE FIGURED DIMENSIONS ONLY



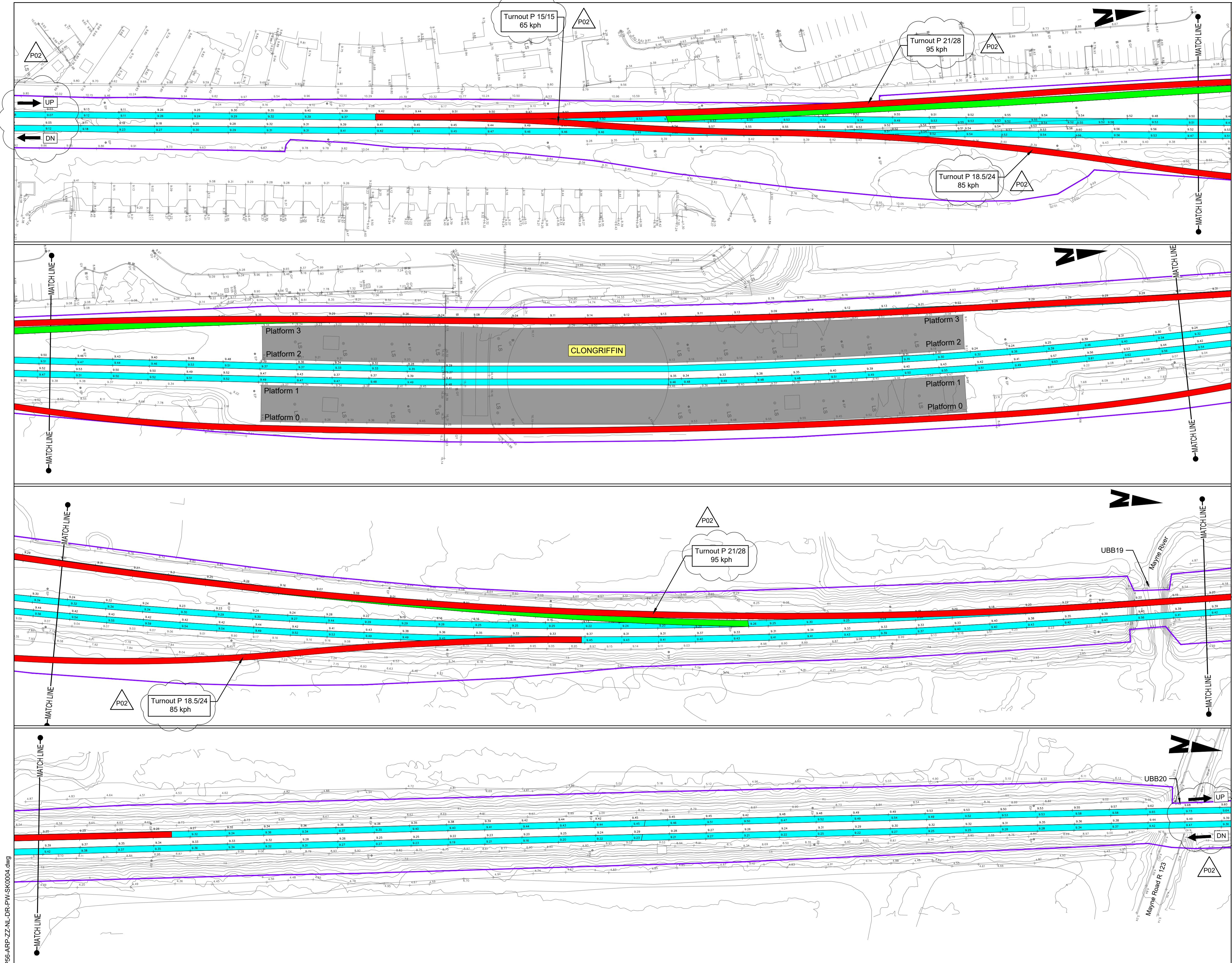

**LEGEND:**

- IRISH RAIL PROPERTY BOUNDARY
- EXISTING RAIL TRACK RETAINED
- EXISTING RAIL TRACK REMOVED
- NEW RAIL TRACK
- EXISTING STATION
- NEW RETAINING WALL

**BRIDGES**

- OBB18C Access road at Clongriffin Station - Overbridge
- UBB19 Mayne River & Cattle Pass - Underbridge
- UBB20 Mayne Road R 123 - Underbridge

**Disclaimer**

© Irish Rail (2021). This drawing is confidential and the copyright in it is owned by Irish Rail. This drawing must not be either loaned, copied or otherwise reproduced in whole or in part or used for any purpose without the prior permission of Irish Rail.

© OpenStreetMap contributors

© Ordnance Survey Ireland and Government of Ireland. All O.S. data used for plans are printed under "Copyright Ordnance Survey Ireland" Survey No. 0039720 (OSi Aerial Data or OSi Lidar Data) & Survey No. 2021051, NMA, 100 (OSi Vector Data). All elevations are in metres and relate to OSi Geoid Model (OSGM02) Mean Head as defined by existing Project Control. All Co-ordinates are in Irish Transverse Mercator Grid (ITM) as defined by OSi active GPS station Tallaght College (TLG5).

Rev	Date	Drn	Chk'd	App'd	Description
P01	30/08/2021	SR	AS	CL	--
P02	10/12/2021	SR	AS	GS	--
P03	19/01/2022	MF	RS	GS	--

**Client**

**Engineering Designer**

**ARUP**

Date: 19/01/2022 Scale: 1:500 @ A1, 1:1000 @ A3

Project Code: D+WP56 Originator Code: ARP

QMS Code: 280275-00

Drawn: MF, Checked: RS, Approved: GS

<b>Project Title</b>		<b>DART+ COASTAL NORTH</b>	
<b>Drawing Title</b>		CLONGRIFFIN STATION GENERAL ARRANGEMENT OPTION - 6	
<b>Drawing File Name</b>	D+WP56-ARP-ZZ-NL-DR-PW-SK0001	<b>Sheet Number</b>	1 of 1
<b>Status</b>	S3	<b>Rev</b>	P03

DO NOT SCALE USE FIGURED DIMENSIONS ONLY