

LEGEND:

- CONSTRUCTION COMPOUND
- LEVEL CROSSING CONSTRUCTION COMPOUND
- SUB-STATION
- SER (Signalling Equipment Room) & PSP (Principal Supply Point) BUILDINGS
- TER (Telecommunication Equipment Room) BUILDINGS
- BRIDGE ALTERATIONS
- CONCRETE TRACK SLAB
- EXISTING ELECTRIFIED DART LINE
- PROPOSED CONCRETE TRACK SLAB & ELECTRIFICATION
- PROPOSED TRACK ALIGNMENT MODIFICATIONS & ELECTRIFICATION
- PROPOSED TRACK ALIGNMENT MODIFICATIONS, NOT ELECTRIFIED
- PROPOSED RAILWAY ELECTRIFICATION
- PARAPET HEIGHTENING
- EXISTING RAILWAY STATION
- PROPOSED LEVEL CROSSING CLOSURE

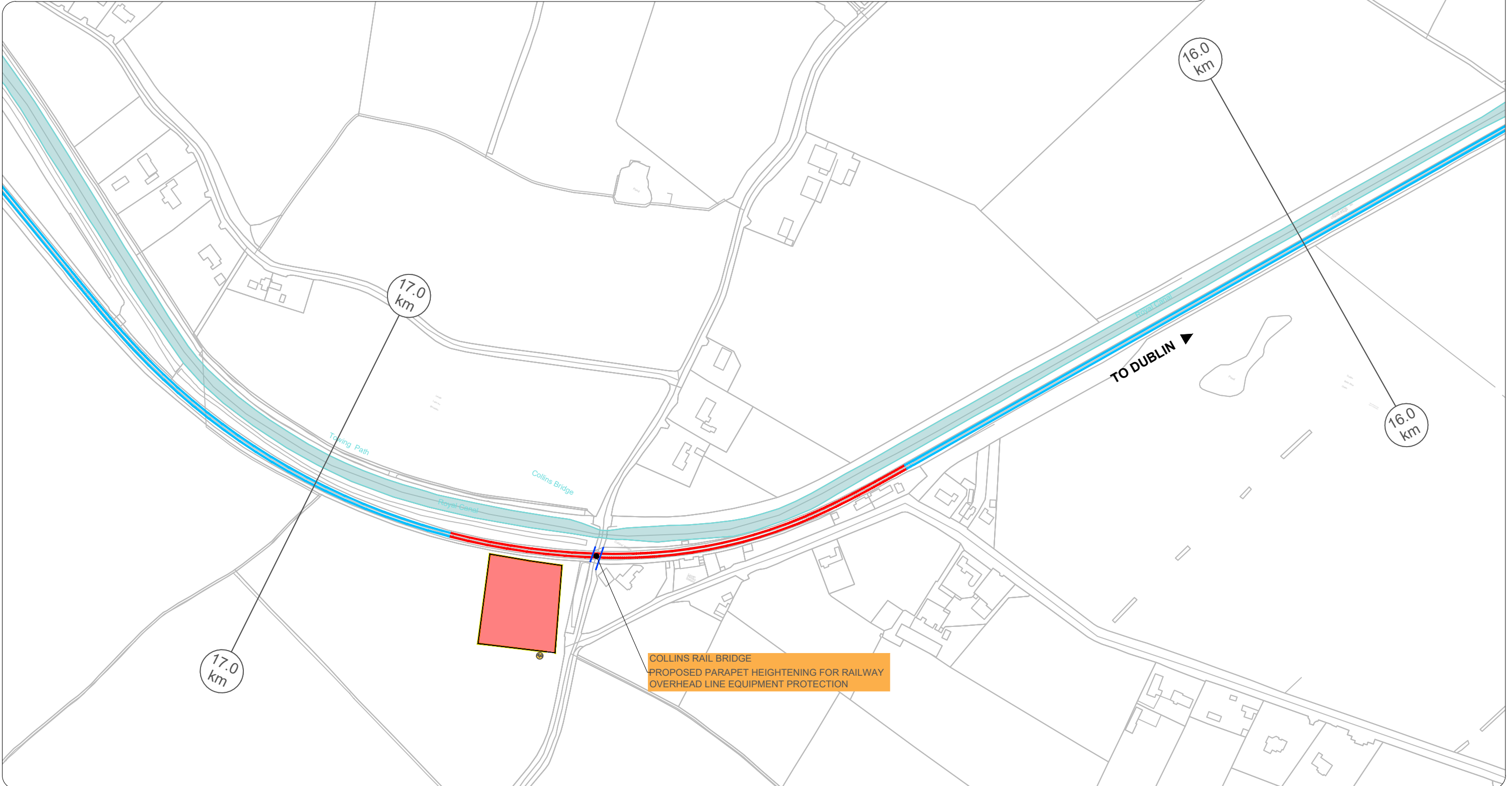
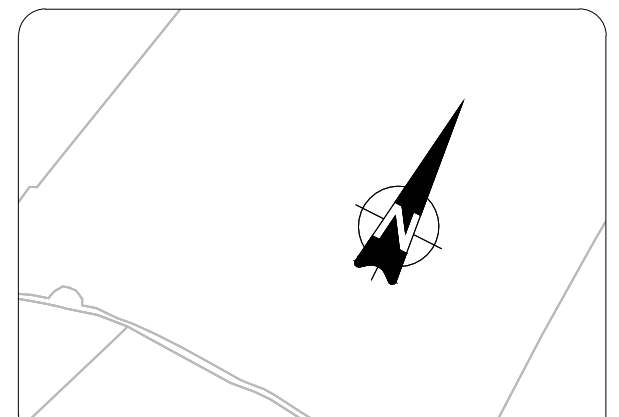
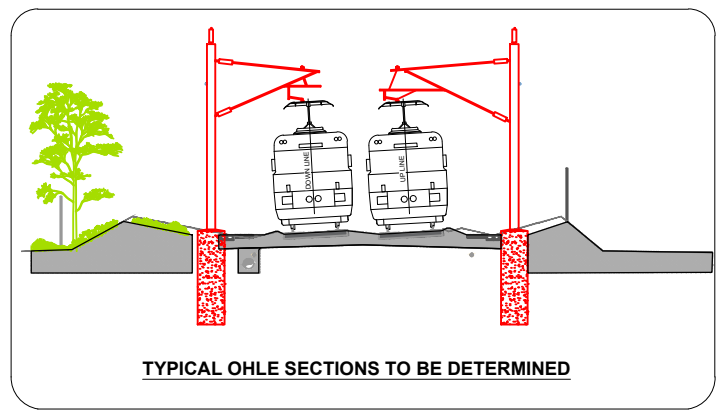

COLLINS RAIL BRIDGE
 PROPOSED PARAPET HEIGHTENING FOR RAILWAY
 OVERHEAD LINE EQUIPMENT PROTECTION

REV.	DATE	DESCRIPTION	MM	TL	BC
V 01	May 2021	PUBLIC CONSULTATION			
PRODUCED BY/REVIEWED BY/APPROVED BY					

© Irish Rail (2021). This drawing is confidential and the copyright in it is owned by Irish Rail. This drawing must not be either loaned, copied or otherwise reproduced in whole or in part or used for any purpose without the prior permission of Irish Rail.
 © Ordnance Survey Ireland and Government of Ireland. All OS data used for this drawing are printed under "Copyright Ordnance Survey Ireland".
 Survey No. 000071 (OS Street View) (2015) and Data. © Survey No. 000000 (OS Street View) (2015) and Data.
 All dimensions are in metres and relate to OS1 (Grid Model 2009/2015) unless stated otherwise by existing project controls.
 All Coordinates are in Irish Transverse Mercator Grid (ITM) as defined by OS1 active GPS station Tallaght College (TLLD).

Client:

Consultant:

Project:

Drawing Title: **OPTIONS SELECTION - SCHEMATIC LAYOUT**
 Sheet 24 of 39

Scale: 1:1,250 @ A0

Drawing Number	Project	Originator	Discipline	Location	Type	Role	Number	Phase
P1101086	MAY MDC CIV ROUT DR						0024	B

Date: May 2021 | Job No: P1101086 | Status: S4 - Suitable for Acceptance | Rev: V 01 | Sheet: 24 of 39