

Plan View  
Plan Scale 1:1000

**Legend:**

- Renewed Track / Slewled Track
- Existing Track to be Retained (Main Lines)
- Existing Track to be Retained (Not Main Lines)
- Existing Track to be Removed
- IE Property Boundary
- Proposed Boundary Limit - Permanent Works
- Design Zone interface / Chainage interface
- Proposed Retaining Wall

- Design is based on topographical survey 09272\_C2\_3D\_R2 2009 in IG coordinates
- All distances in metres unless otherwise stated.
- The layout shows the Permanent Way Option 1. This alternative represents the connection between Inchicore Works Option 3 and all Permanent Way alternatives at South Circular Road. This alignment maintains the standard 10-foot track interval of 3.6m
- Design chainage are based on project chainages as defined in DP-04-23-REP-PM-TTA-01144-v03-S03.
- Further investigation required for the crossovers location.
- Walkways could be installed on either cess.
- New drainage is to be installed. New attenuation facilities will be required at Heuston area.
- Slow tracks to be electrified.

**NOTE:**

INFORMATION IS PRESENTED FOR PUBLIC CONSULTATION NO.1

NOT ALL DESIGN DETAIL OR CONSTRUCTION RELATED DETAIL ARE KNOWN AT THIS TIME. E.G. SUBSTATION LOCATIONS, CONSTRUCTION COMPOUNDS, TEMPORARY BRIDGE REQUIREMENTS, TEMPORARY UTILITY DIVERSIONS AND OTHER ELEMENTS

POTENTIAL INTERFERENCE WITH PROPERTY RIGHTS IS BASED ON THE LEVEL OF INFORMATION AND DESIGN AVAILABLE AT THIS TIME. FURTHER WORK INCLUDING DETAILED DESIGN AND TECHNICAL AND CONSTRUCTION RELATED SOLUTIONS WILL SEEK TO MINIMISE POTENTIAL INTERFERENCE WITH PROPERTY RIGHTS

© Irish Rail (2021). This drawing is confidential and the copyright in it is owned by Irish Rail. This drawing must not be either loaned, copied or otherwise reproduced in whole or in part or used for any purpose without the prior permission of Irish Rail.

© Ordnance Survey Ireland and government of Ireland. All O.S. Data used for plans are printed under: "Copyright Ordnance Survey Ireland" Survey No. 0039721. (OSi Aerial Data or OSi Lidar Data) & Survey No. 2020/OSi\_NMA\_180 (OSi Vector Data).

All elevations are in metres and relate to OSi Geoid Model (OSGM02) Main Head as defined by existing Project Control.

All Co-ordinates are in Irish Transverse Mercator Grid (ITM) as defined by OSi active GPS station Tallaght College (TLLG).

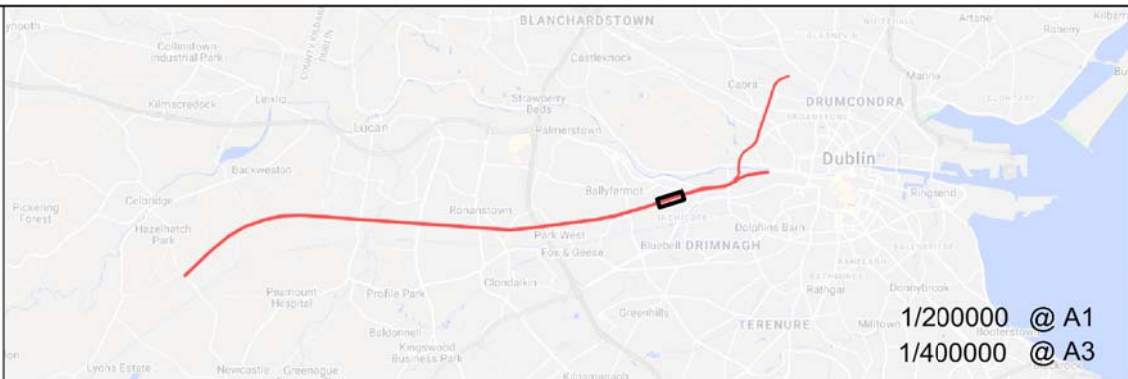

Rev	Date	Dm	Chk'd	App'd	Description
v01	21/04/2021	JYM	FJC	AG	FOR PUBLIC CONSULTATION No1

**Client**

**Engineering Designer**  
  
Supported by:

**Date**  
Scale 1:1000 @ A1  
1:2000 @ A3

**Project Code**  
ATK

**Drawn**  
JYM

**Checked**  
FJC

**Approved**  
AG

**QMS Code**

Project Title	Drawing Title	Drawing File Name	Version	Status
DART + SOUTH WEST	SARSFIELD ROAD BRIDGE (UBC4) & MEMORIAL ROAD BRIDGE (OBC3) TRACK PLAN LAYOUT PERMANENT WAY OPTION 1	DP-04-23-DWG-PW-TTA-55830	V01	S3

DO NOT SCALE USE FIGURED DIMENSIONS ONLY







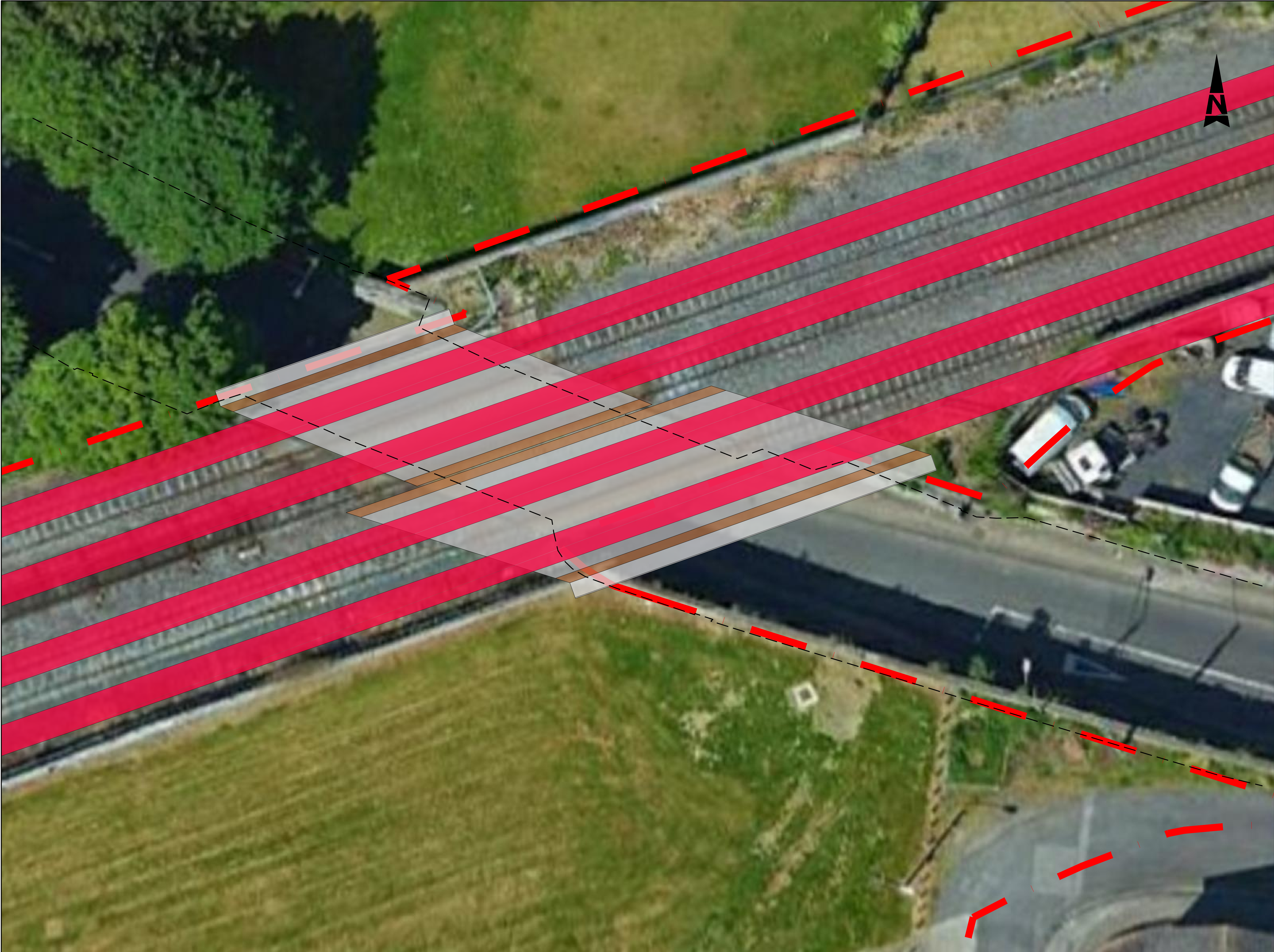

LEGEND :-

IRISH RAIL PROPERTY  
BOUNDARY

Preferred

© Irish Rail (2021). This drawing is confidential and the copyright in it is owned by Irish Rail. This drawing must not be either loaned, copied or otherwise reproduced in whole or in part or used for any purpose without the prior permission of Irish Rail.  
© Ordnance Survey Ireland and government of Ireland. All O.S. Data used for plans are printed under: "Copyright Ordnance Survey Ireland" Survey No. 0039721. (OSi Aerial Data or OSi Lidar Data) & Survey No. 2020/OSI\_NMA\_180 (OSi Vector Data). All elevations are in metres and relate to OSi Geoid Model (OSGM02) Mean Head as defined by existing Project Control. All Co-ordinates are in Irish Transverse Mercator Grid (ITM) as defined by OSi active GPS station Tallaght College (TLLG).

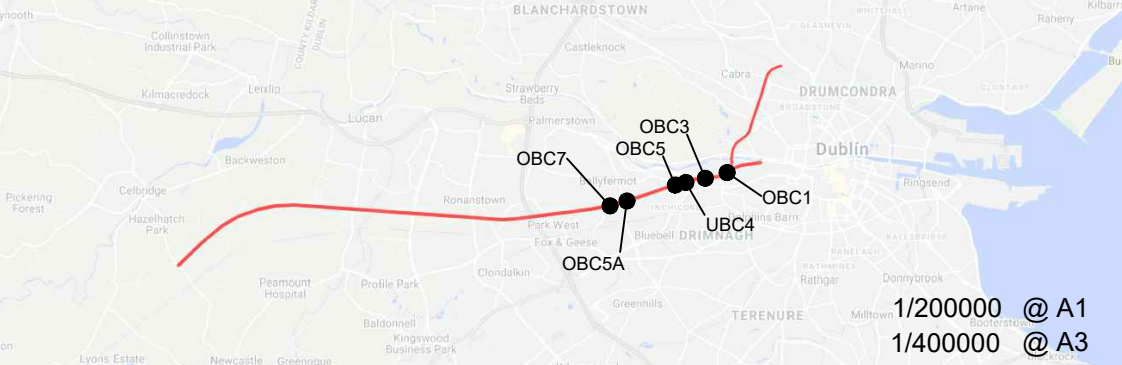

Rev	Date	Dm	Chk'd	App'd	Description
v01	21/04/21	AOS	RM	AG	FOR PUBLIC CONSULTATION No1

Client	
Iarnród Éireann Irish Rail	
Date	28/01/21
Scale	NTS @ A1 NTS @ A3
Project Code	5199586
Issuer	TTA

Engineering Designer	
ATKINS	
Supported by: TYPESA	
Drawn	AOS
Checked	RM
Approved	AG
QMS Code	

Project Title	
DART+ SOUTH WEST	
Drawing Title	
SARSFIELD ROAD BRIDGE (UBC4) OPTION 2 - GENERAL ARRANGEMENT	
Drawing File Name	
DP-04-23-DWG-ST-TTA-55956	
Version	v01
Status	S3

DO NOT SCALE USE FIGURED DIMENSIONS ONLY

C:\AOS Temp\5199586 Kildare DART\Latest Drawings & Xrefs\DP-04-23-DWG-ST-TTA-55956.dwg



C:\AOS Temp\5199586 Kildare DART\Latest Drawings & Xrefs\DP-04-23-DWG-ST-TTA-55957.dwg

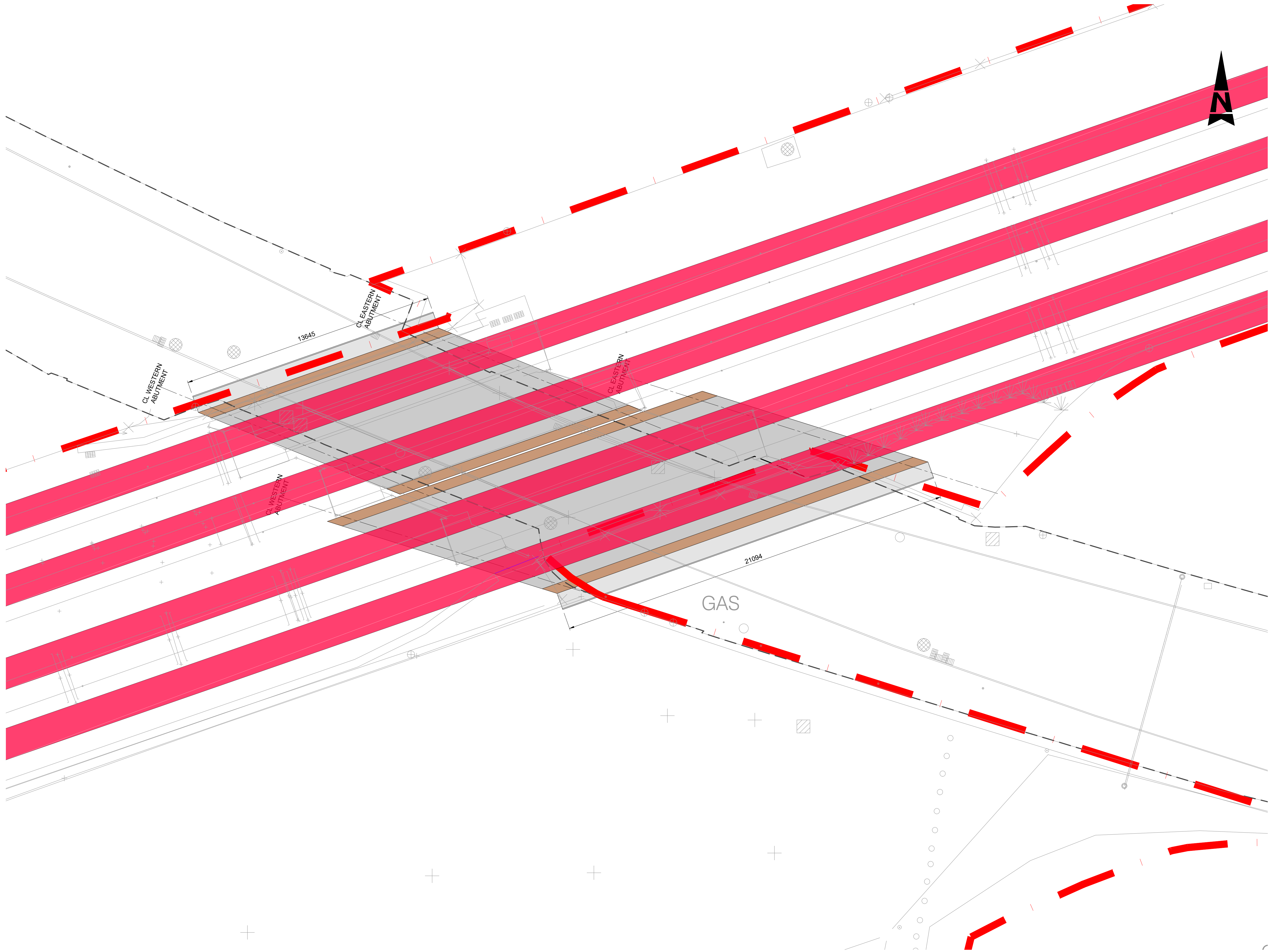

LEGEND :-

IRISH RAIL PROPERTY  
BOUNDARY

Preferred

© Irish Rail (2021). This drawing is confidential and the copyright in it is owned by Irish Rail. This drawing must not be either loaned, copied or otherwise reproduced in whole or in part or used for any purpose without the prior permission of Irish Rail.  
© Ordnance Survey Ireland and government of Ireland. All O.S. Data used for plans are printed under: "Copyright Ordnance Survey Ireland" Survey No. 0039721. (OSi Aerial Data or OSi Lidar Data) & Survey No. 2020/OSi\_NMA\_180 (OSi Vector Data). All elevations are in metres and relate to OSi Geoid Model (OSGM02) Mean Head as defined by existing Project Control. All Co-ordinates are in Irish Transverse Mercator Grid (ITM) as defined by OSi active GPS station Tallaght College (TLLG).

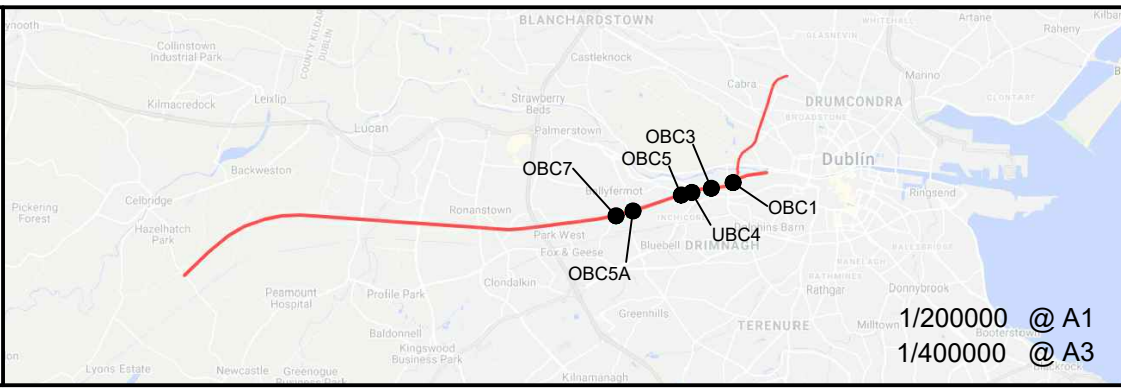

Rev	Date	Dm	Chk'd	App'd	Description
v01	21/04/21	AOS	RM	AG	FOR PUBLIC CONSULTATION No1

Client  
**Iarnród Éireann**  
**Irish Rail**

Date 28/01/21 Scale 1:100 @ A1  
1:200 @ A3

Project Code 5199586 Issuer TTA

Engineering Designer  
**ATKINS**  
Supported by **TYPESA** Member of the SNC-Lavalin Group  
**rps**

Drawn AOS Checked RM Approved AG

QMS Code

Project Title	DART+ SOUTH WEST		
Drawing Title	SARSFIELD ROAD BRIDGE (UBC4) OPTION 2 - BRIDGE DECK GENERAL ARRANGEMENT		
Drawing File Name	DP-04-23-DWG-ST-TTA-55957	Version v01	Status S3

DO NOT SCALE USE FIGURED DIMENSIONS ONLY



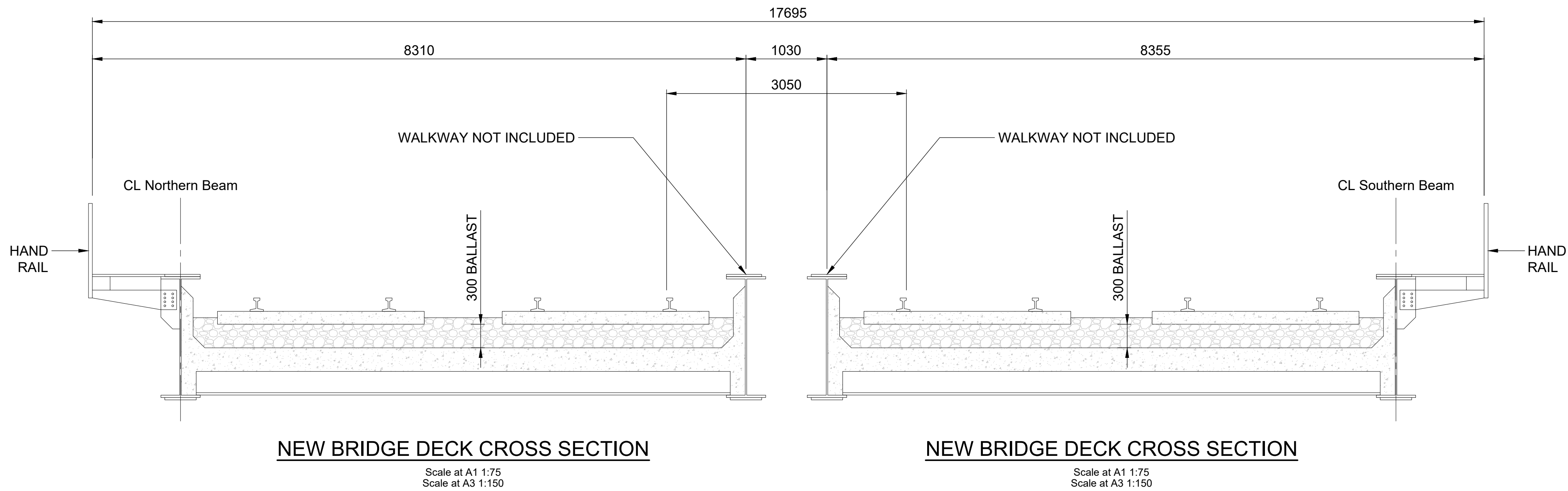

2 x NEW BRIDGE DECKS BASED ON ALTERNATIVE 4 TRACK ALIGNMENT

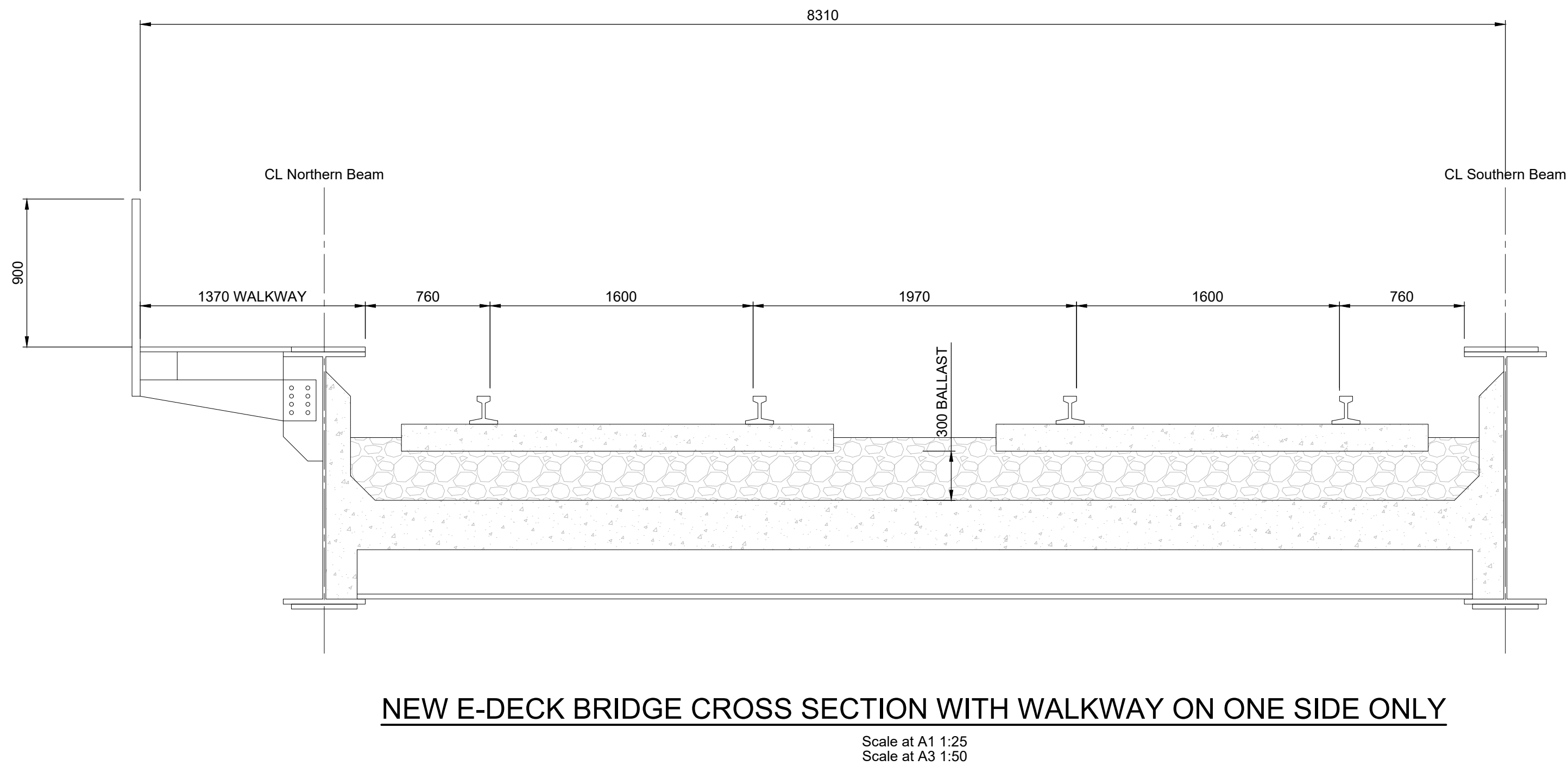

Preferred

© Irish Rail (2021). This drawing is confidential and the copyright in it is owned by Irish Rail. This drawing must not be either loaned, copied or otherwise reproduced in whole or in part or used for any purpose without the prior permission of Irish Rail.  
© Ordnance Survey Ireland and government of Ireland. All O.S. Data used for plans are printed under: "Copyright Ordnance Survey Ireland" Survey No. 0039721, (OSi Aerial Data or OSi Lidar Data) & Survey No. 2020/OSi\_NMA\_180 (OSi Vector Data). All elevations are in metres and relate to OSi Geoid Model (OSGM02) Mean Head as defined by existing Project Control. All Co-ordinates are in Irish Transverse Mercator Grid (ITM) as defined by OSi active GPS station Tallaght College (TLLG).

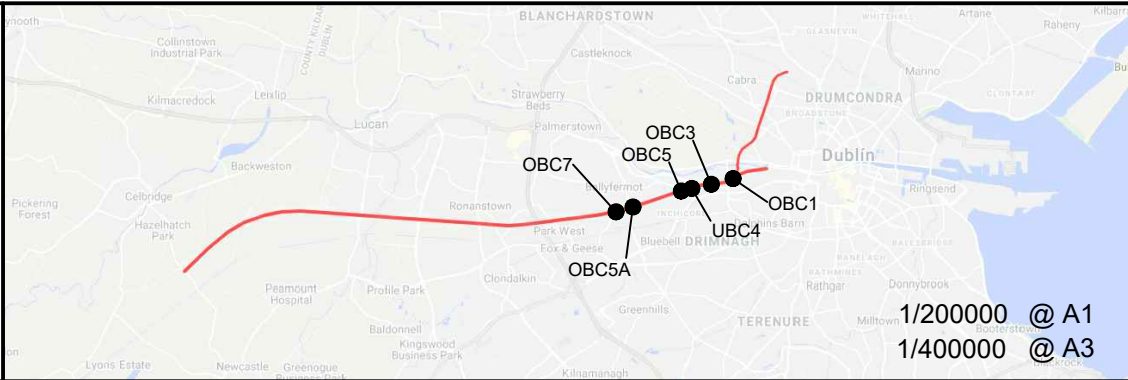

Rev	Date	Dm	Chk'd	App'd	Description
v01	21/04/21	AOS	RM	AG	FOR PUBLIC CONSULTATION No1

Client	
Iarnród Éireann Irish Rail	
Date	28/01/21
Project Code	5199586
Issuer	TTA

Engineering Designer	
ATKINS	
Supported by: rps	
Drawn	AOS
Checked	RM
Approved	AG
QMS Code	

Project Title	
DART+ SOUTH WEST	
Drawing Title	
SARSFIELD ROAD BRIDGE (UBC4) OPTION 2 - BRIDGE DECK CROSS SECTIONS	
Drawing File Name	
DP-04-23-DWG-ST-TTA-55958	
Version	v01
Status	S3

DO NOT SCALE USE FIGURED DIMENSIONS ONLY



C:\AOS Temp\5199586 Kildare DART\Latest Drawings & Xrefs\DP-04-23-DWG-ST-TTA-55959.dwg

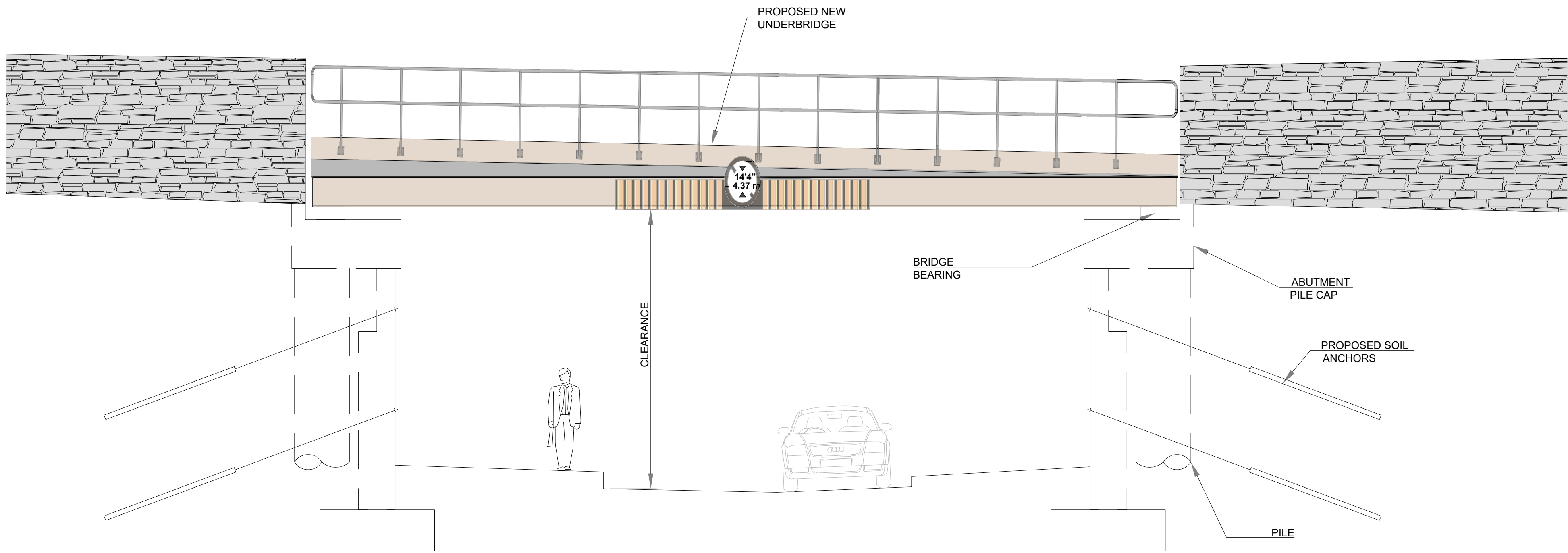

INDICATIVE ELEVATION ON SOUTH BRIDGE

Scale at A1 1:100  
Scale at A3 1:200

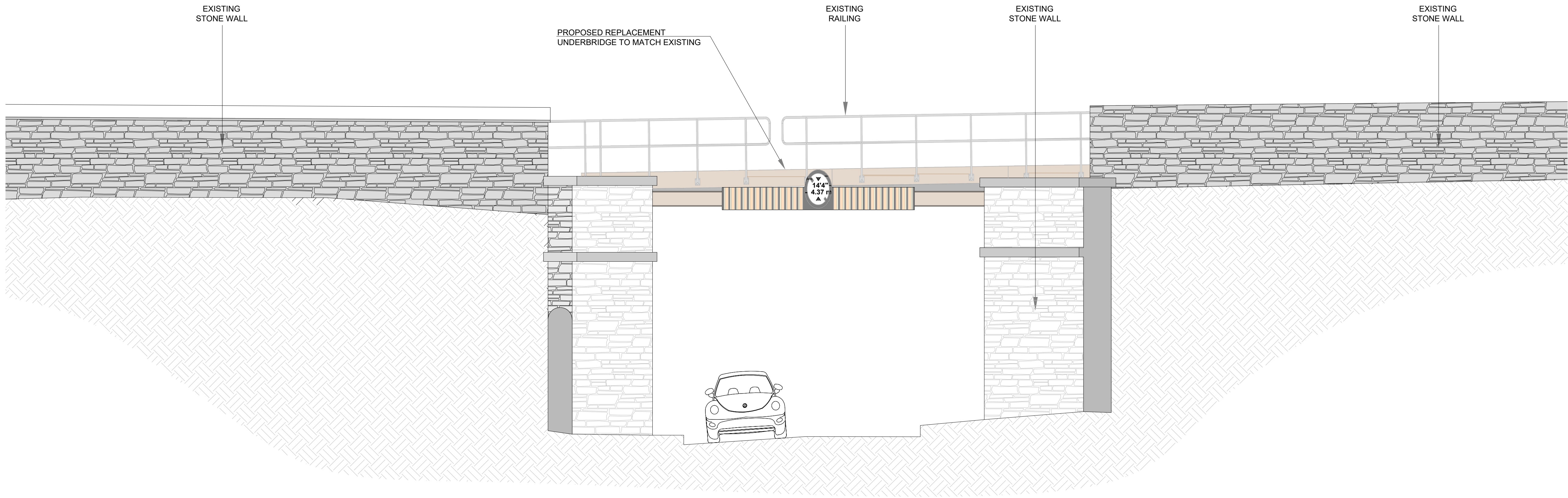

INDICATIVE ELEVATION ON NORTH BRIDGE

Scale at A1 1:100  
Scale at A3 1:200

Preferred

© Irish Rail (2021). This drawing is confidential and the copyright in it is owned by Irish Rail. This drawing must not be either loaned, copied or otherwise reproduced in whole or in part or used for any purpose without the prior permission of Irish Rail.  
© Ordnance Survey Ireland and government of Ireland. All O.S. Data used for plans are printed under: "Copyright Ordnance Survey Ireland" Survey No. 0039721, (OSi Aerial Data or OSi Lidar Data) & Survey No. 2020/OSi\_NMA\_180 (OSi Vector Data). All elevations are in metres and relate to OSi Geoid Model (OSGM02) Main Head as defined by existing Project Control. All Co-ordinates are in Irish Transverse Mercator Grid (ITM) as defined by OSi active GPS station Tallaght College (TLLG).

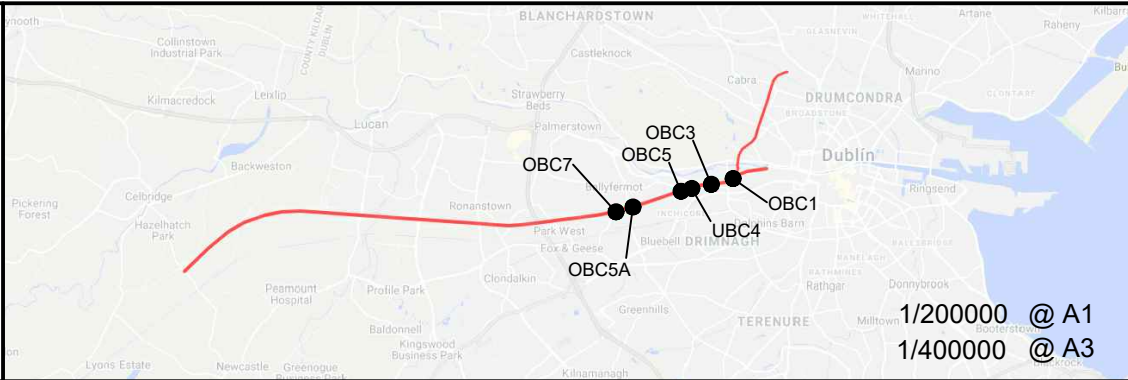

1/200000 @ A1  
1/400000 @ A3

**DART+ South West**



Rev	Date	Dwn	Chk'd	App'd	Description
V01	21/04/2021	AOS	RM	AG	FOR PUBLIC CONSULTATION NO1

Client <b>Iarnród Éireann Irish Rail</b>	
Date 28/01/21	Scale 1:50 @ A1 1:100 @ A3
Project Code 5199586	Issuer TTA

Engineering Designer <b>ATKINS</b> Member of the SNC-Lavalin Group Supported by <b>rps</b>		
Drawn AOS	Checked RM	Approved AG
QMS Code		

Project Title <b>DART+ SOUTH WEST</b>		
Drawing Title <b>SARSFIELD ROAD BRIDGE (UBC4) OPTION 2 - SOUTHERN BRIDGE ELEVATION</b>		
Drawing File Name DP-04-23-DWG-ST-TTA-55959	Version v01	Status S3

DO NOT SCALE USE FIGURED DIMENSIONS ONLY